

# IF YOU'RE SHIPPING GLASS, WE'RE GONNA GIVE YOU SOME LIP.

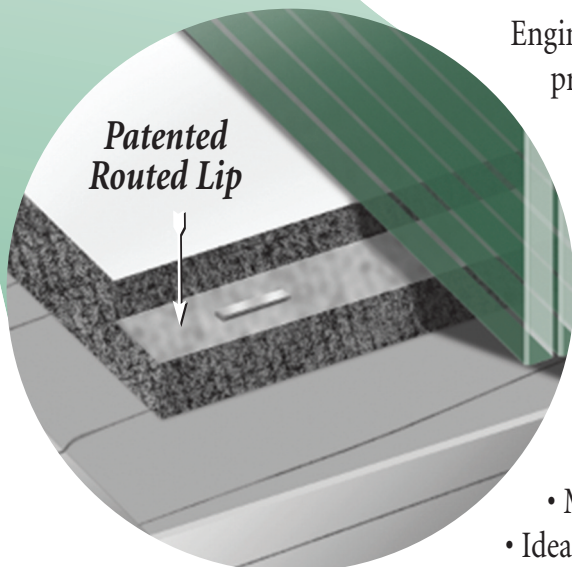

Engineered with a unique 1/2-inch routed lip, new *Staple-Safe® Glass Pads* protect glass shipments from staple damage. With Staple-Safe Glass Pads, loose or rising staples stay well below glass surfaces to reduce breakage. Homasote *Staple-Safe Glass Pads* maintain their integrity under load, prevent damage from moisture and acid, and provide maximum safety from particulate matter migrating between lites.

## Pak-Line Staple-Safe Glass Pads - The Safest Way To Ship Glass – Maximum Protection for Shipping Glass Lites

- Neutral Ph
- Moisture-resistant
- Ideal load cushioning
- Uniform in size and density
- Shipped on easy-to-access skids, ready to install
- Dry and splinter-free

See reverse side for Staple-Safe®, IG and Slip Load Pad information.

# EXCLUSIVELY FROM PAK-LINE®

## STAPLE-SAFE® SLIP LOAD PADS

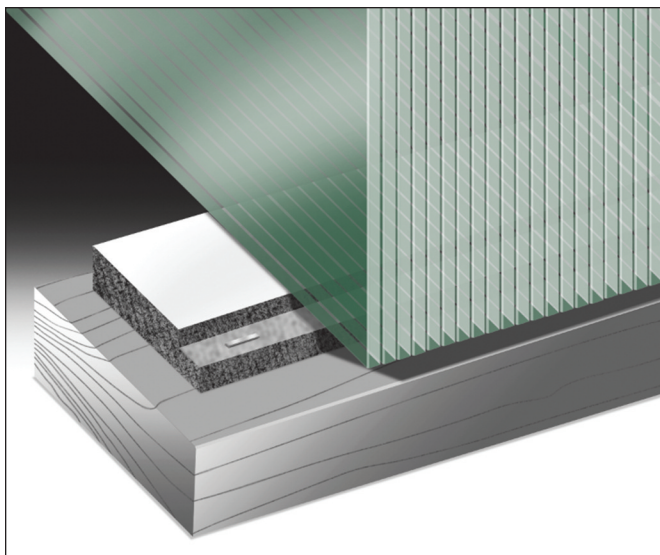

Designed with a slick surface, **Staple-Safe Slip Load Pads** let you slide lites into the crate with a minimum of scuffing. Virtually eliminate damaging pressure points caused by scuffing with **Staple-Safe Slip Load Pads**. Also available without slip-loading coating.

## IG LOAD PADS

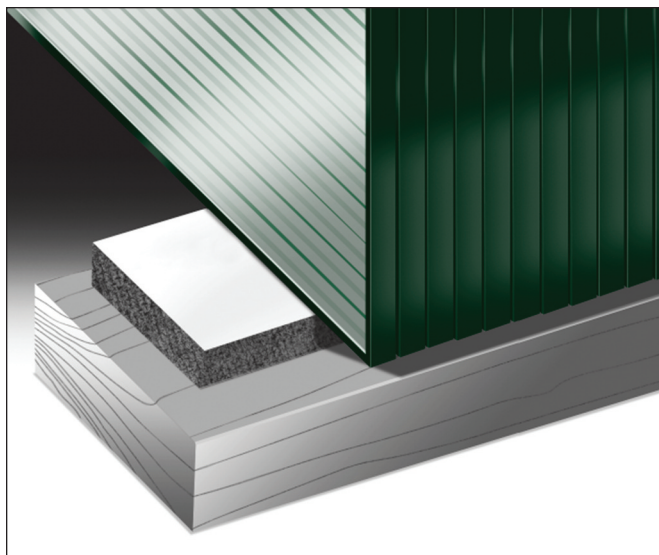

The surface of **IG Load Pads** is specially treated to prevent sealant from bonding to the pads. You can pack while “wet.” **IG Load Pads** create a neat, secure pack and eliminate the need for specially coated storage racks or potentially dangerous make-shift arrangements.

### DELIVERED READY TO USE

Pak-Line Glass Pads make it faster and safer than ever to pack glass. They are delivered in easy-to-access, neatly packed skids. Place them directly in the packing area for quick, convenient use.

### AVAILABLE IN A WIDE CHOICE OF SIZES

Pak-Line Glass Pads are available in the right size for every glass shipment.

	Staple Safe Pads	IG Load Pads
Thickness	7/16"	7/16"
Width(s)	3-1/2" wide with 3" surface	2-1/2" or 3"
Standard Length(s)	31" - 48", 96", 120"	48"

All Sizes Nominal

**Pak-Line®**  
Registered Trademark of the Homasote Company

For a trial PAK please contact:

**HOMASOTE®**

**Sensible. Sound.  
Solutions.**



800-257-9491 • Technical Support call Ext. 1332 or e-mail [techhelp@homasote.com](mailto:techhelp@homasote.com)

[www.homasote.com](http://www.homasote.com)