

## INSTALLATION HIGHLIGHTS • 440 SOUNDBARRIER FLOORS



Sensible. Sound.  
Solutions.



The mark of  
responsible forestry



**1 Acclimate materials** – Make sure you place the material in the location in which they will be installed for at least 24 hours prior to installation.

**2 Clean the floor** – floor must be swept clean of any dust and debris that would prevent the boards from installing flat or adhering to the floor.

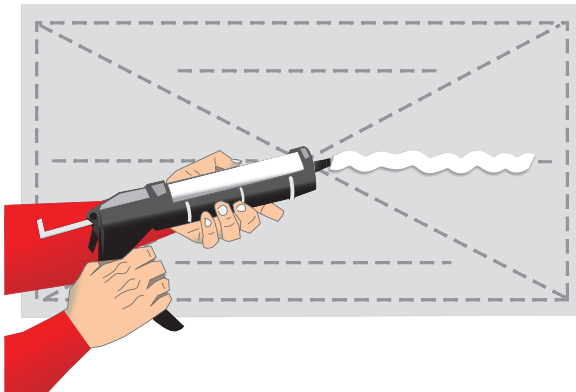

**3 Apply 3/8" bead of subfloor adhesive** that meets the specification APA AFG-01 (such as Liquid Nails or PL400) in the pattern shown in the graphic.

**4 Make sure you do not butt the boards** up to one another; leave a gap for expansion between adjoining boards about the thickness of a paint stirrer. **Leave a gap of 3/8" at walls.**

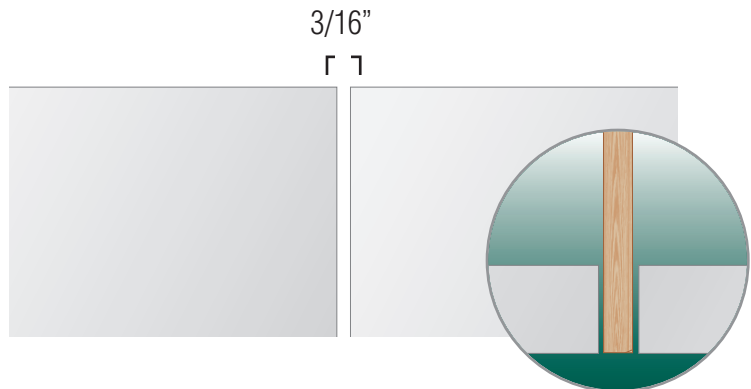

\* Please note that all of our lab and field sound tests are conducted with the gaps between the boards

## INSTALLATION HIGHLIGHTS • 440 SOUNDBARRIER FLOORS

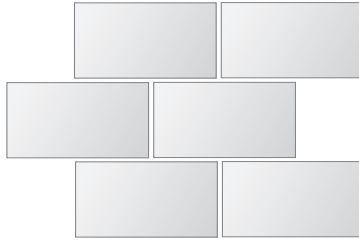
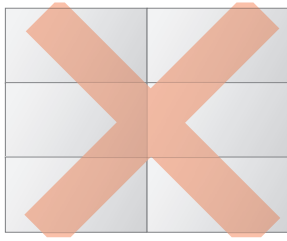

**5** Joints **must be staggered**.

**6** Use **threaded nails** or coarse **threaded screws** and follow the pattern that is shown.

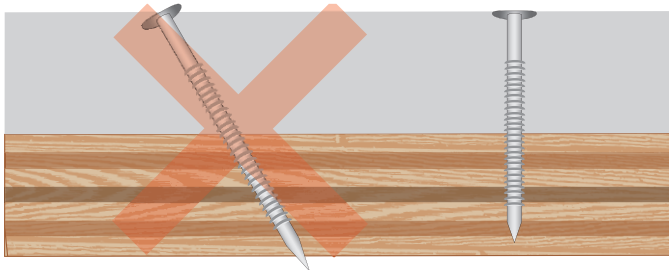
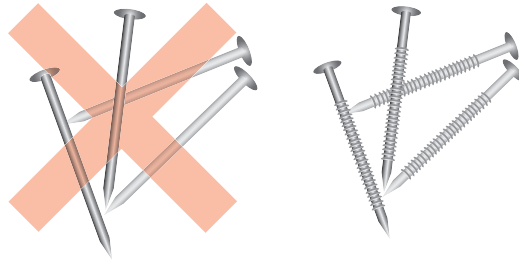

**7** Drive 1" threaded nails or coarse threaded screws **straight** into subfloor, **but not through** the subfloor.



**8** Glue and fastener pattern for 4' x 4' panels required for certain applications.

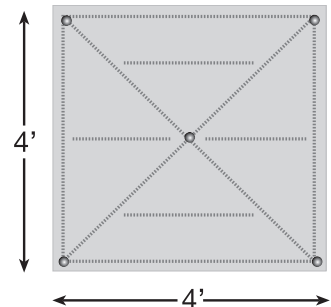

**9** Please make sure to **read our installation instructions** related to your type of finished floor, as 440 SoundBarrier installation procedures vary.

**440 SoundBarrier®**

**HOMASOTE®**

*Sensible. Sound.  
Solutions.*



800-257-9491 • Technical Support call Ext. 1332 or e-mail [techhelp@homasote.com](mailto:techhelp@homasote.com)

**www.homasote.com**