

INSTALLATION HIGHLIGHTS • 440 SOUNDBARRIER FLOORS



Sensible. Sound.
Solutions.



The mark of responsible forestry



1 Acclimate materials – Make sure you place the material in the location in which they will be installed for at least 24 hours prior to installation.

2 Clean the floor – floor must be swept clean of any dust and debris that would prevent the boards from installing flat or adhering to the floor.

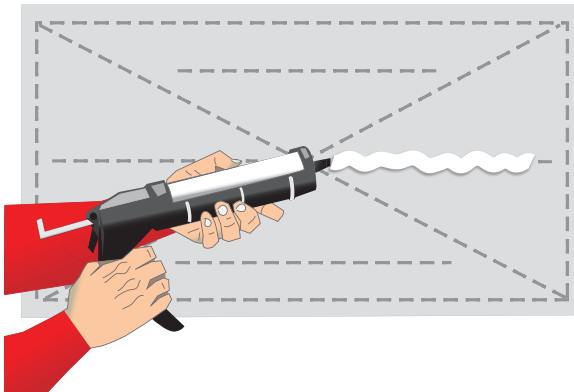

3 Apply 3/8" bead of subfloor adhesive that meets the specification APA AFG-01 (such as Liquid Nails or PL400) in the pattern shown in the graphic.

4 Make sure you do not butt the boards up to one another; leave a gap for expansion between adjoining boards about the thickness of a paint stirrer. **Leave a gap of 3/8" at walls.**

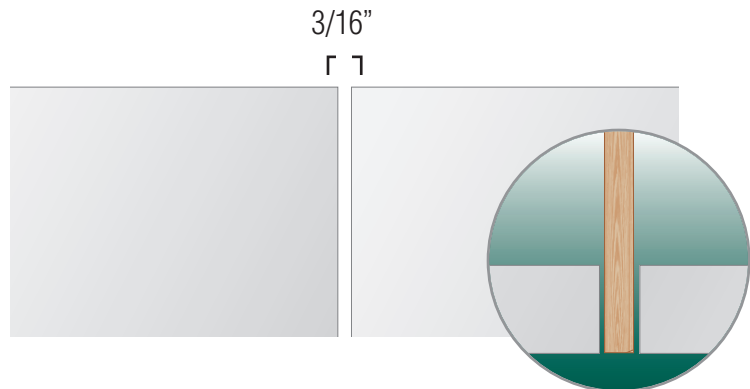

* Please note that all of our lab and field sound tests are conducted with the gaps between the boards

INSTALLATION HIGHLIGHTS • 440 SOUNDBARRIER FLOORS

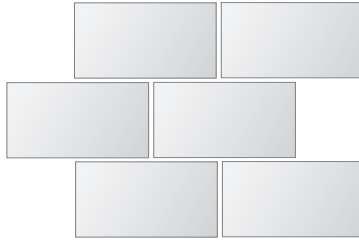
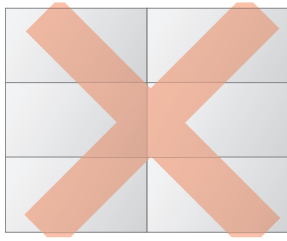

5 Joints must be staggered.

6 Use **threaded nails** or coarse **threaded screws** and follow the pattern that is shown.

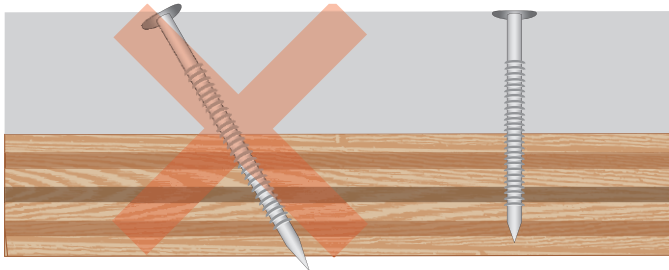
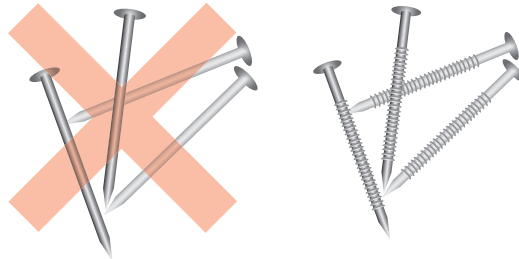

7 Drive 1" threaded nails or coarse threaded screws **straight** into subfloor, **but not through** the subfloor.

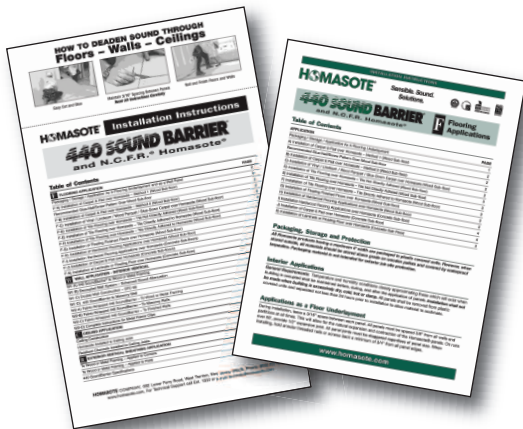

8 Glue and fastener pattern for 4' x 4' panels required for certain applications.

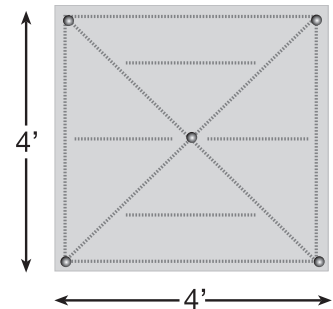

9 Please make sure to **read our installation instructions** related to your type of finished floor, as 440 SoundBarrier installation procedures vary.

440 SoundBarrier®

HOMASOTE®

*Sensible. Sound.
Solutions.*



800-257-9491 • Technical Support call Ext. 1332 or e-mail techhelp@homasote.com

www.homasote.com